



WEBER STATE
UNIVERSITY

STATE OF THE UNIVERSITY

May 17, 2013



GOOD NEWS AT WEBER STATE



WEBER STATE
UNIVERSITY

Historic season for men's basketball

- Big Sky record for most wins in season (30-7)
- Advanced to College Insider.com Tournament championship game
- Scott Bamforth and Davion Berry named to Big Sky Team



WEBER STATE
UNIVERSITY

Former Wildcat Damian Lillard Unanimous 2012-13 Rookie of the Year



WEBER STATE
UNIVERSITY

WSU launches Charter Academy

- On-site kindergarten opens Fall 2013
- Utah's first charter academy authorized by an institution of higher education



WEBER STATE
UNIVERSITY

Governor honors physics professor Adam Johnston

- 2013 Governor's Medals for Science and Technology in Science Education
- Johnston founded WSU's Science in the Parks program in 2007



Named Best Radiologic Technologist Training Program for 2012*

- WSU's Department of Radiologic Sciences edges Johns Hopkins University for top honor

** Presented by the Minnies – the premier professional organization for medical imaging*

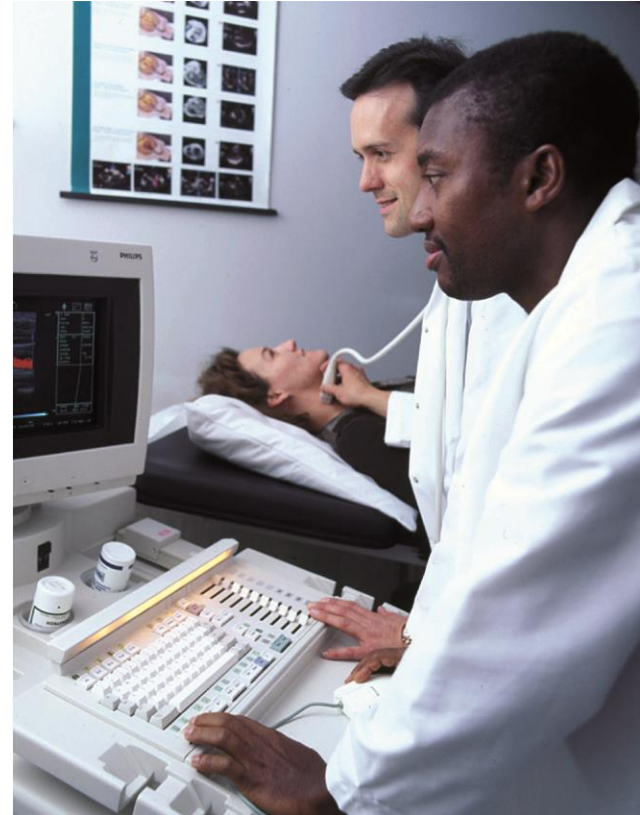

WEBER STATE
UNIVERSITY

Computer Science Professor Organizes Student Project in Ghana

- Dr. Richard Fry oversaw a student project to design, deliver, and implement an “Open Source” Electronic Medical Records (EMR) system for a 1700-bed hospital in Ghana.
- More than two dozen WSU students traveled to West Africa to assist.



WEBER STATE
UNIVERSITY

Botany major plants seeds for community gardens

- Monica Romney started community garden at WSU
- Success led to outreach effort teaching low-income youth at Marshall White Center how to plan and grow their own gardens



Facts & Figures

ENROLLMENT



WEBER STATE
UNIVERSITY

Enrollment Trends

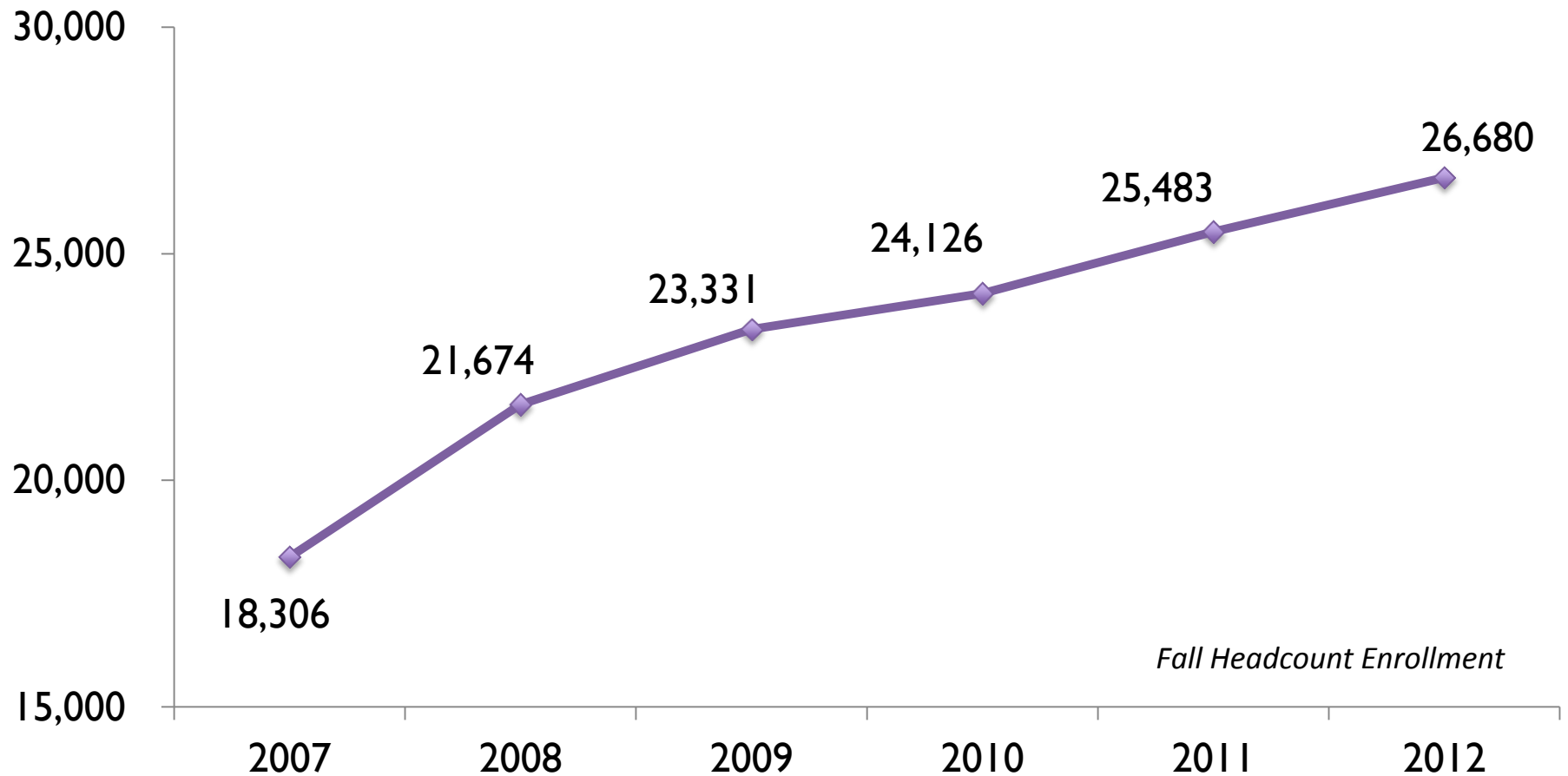

Where WSU Students Come From

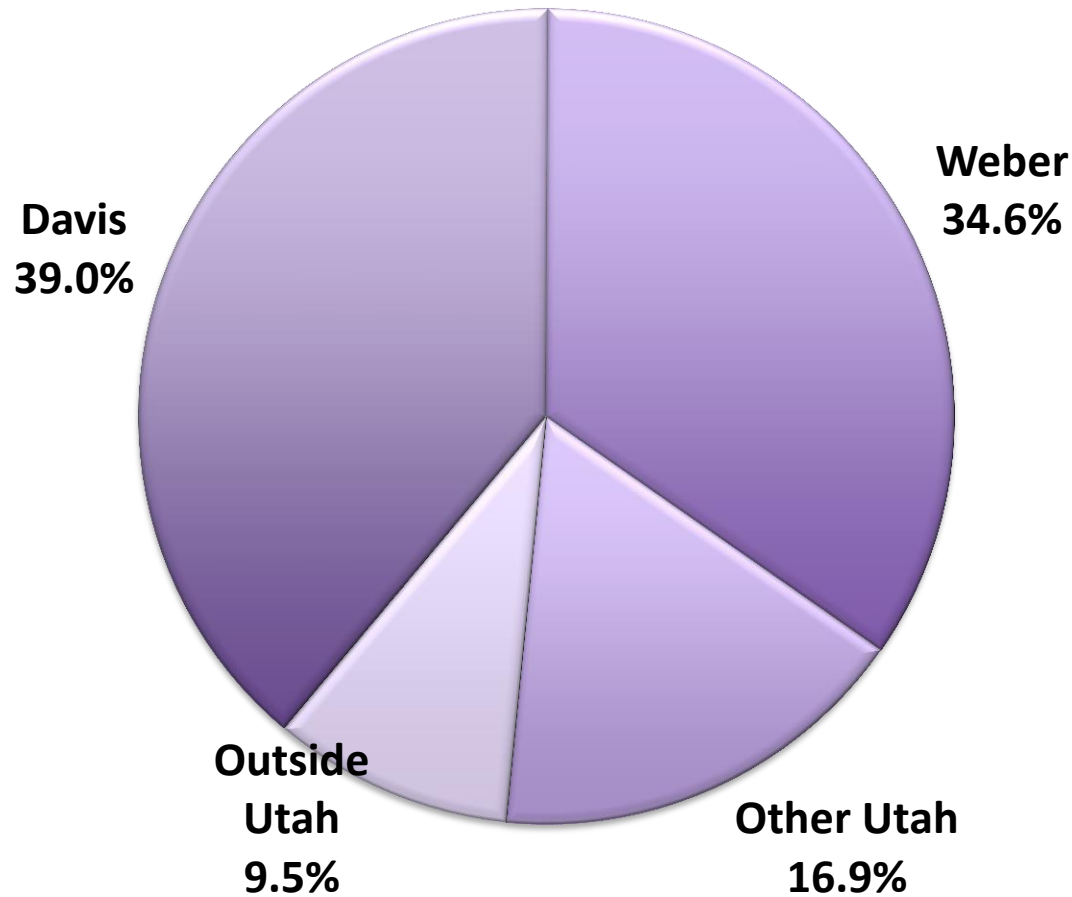

Fall 2012



WEBER STATE
UNIVERSITY

Internet-based Instruction

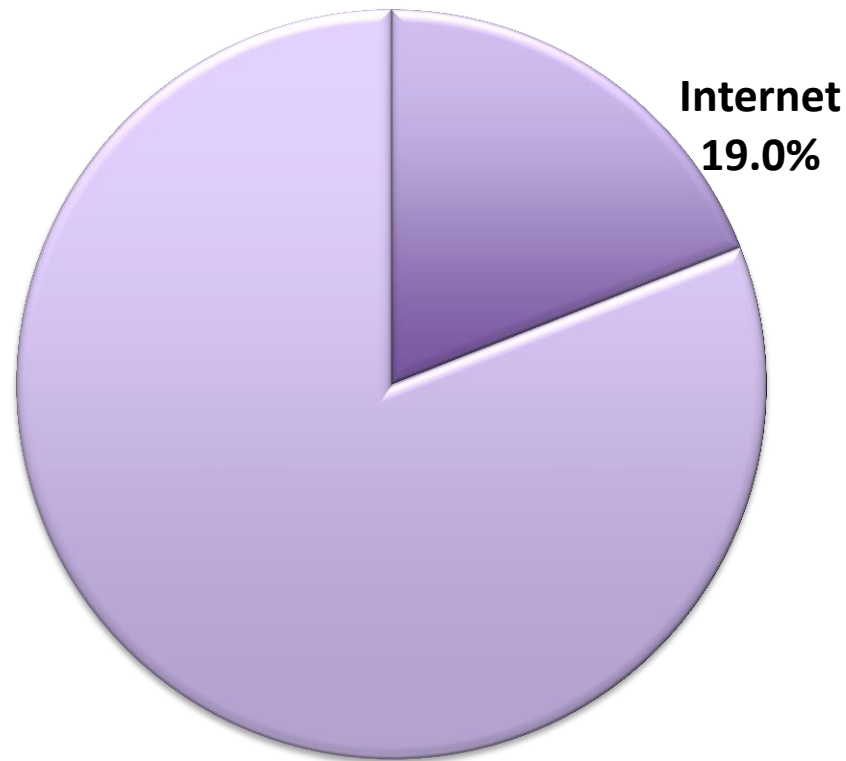

Percent of credit hours taken in 100% online courses, Fall 2012



WEBER STATE
UNIVERSITY

Minority Enrollment Trends

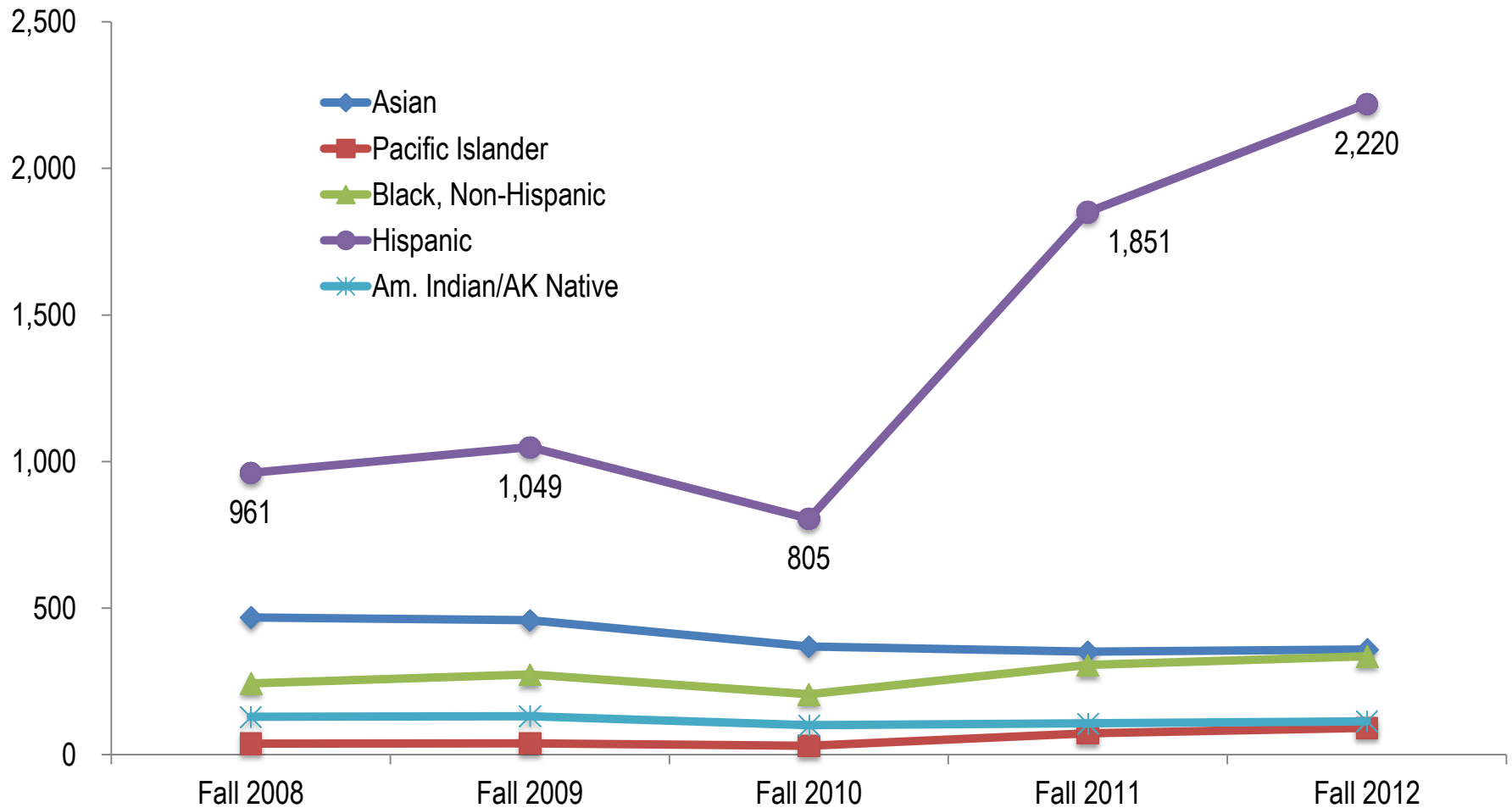

Facts & Figures

RETENTION



WEBER STATE
UNIVERSITY

Progress on Developmental Math

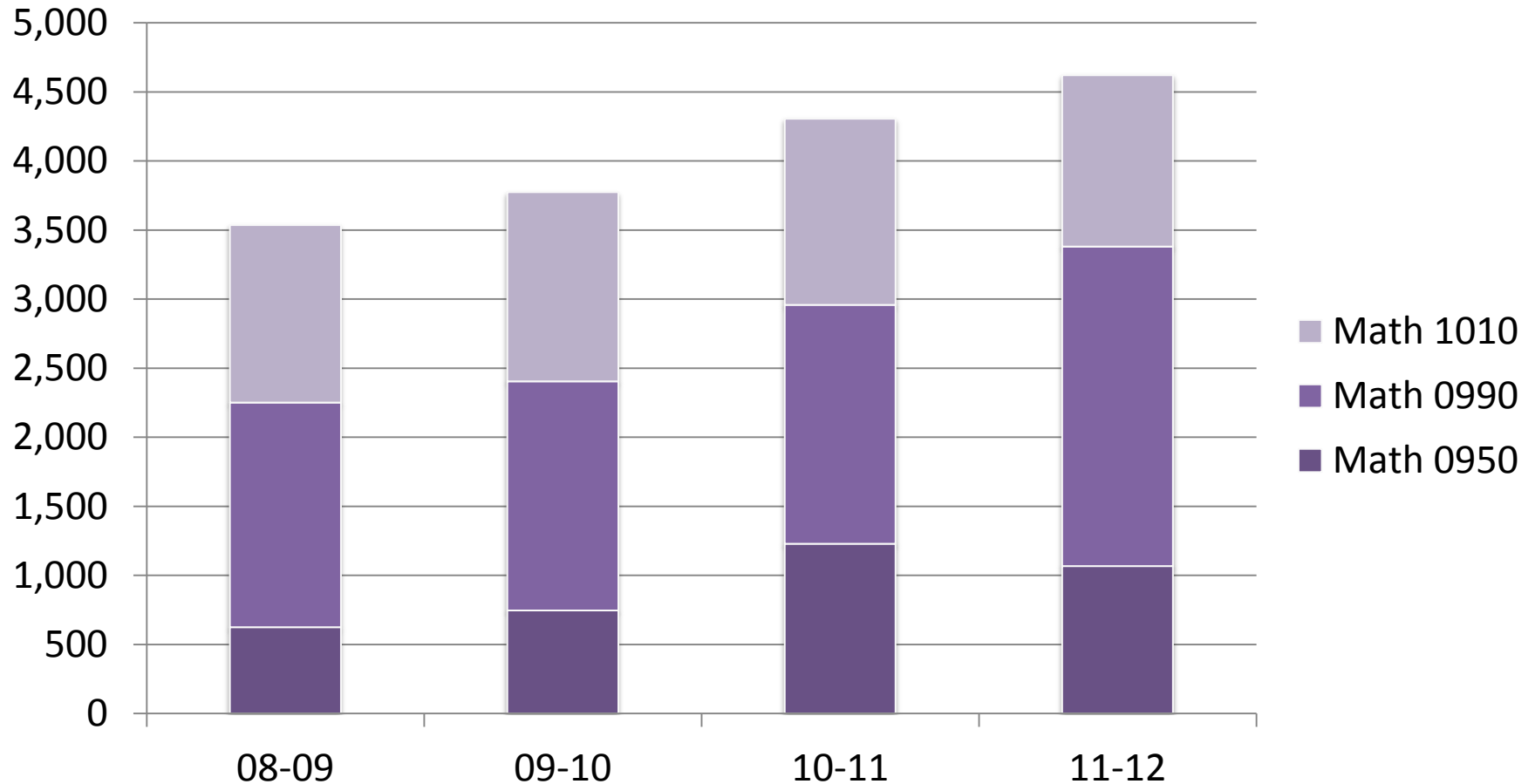

Number of Successful Completions



WEBER STATE
UNIVERSITY

TERM Project Concept

- Emporium Model based on extensive use of computer laboratory learning environment
- Uses well-developed software plus extensive tutoring for time on task.
- Significantly improved student performance related to identified learning outcomes
- Software provides immediate feedback to the student on missed homework problems
- More effective use of instructor time with students
- Much less tedious and time-intensive grading (if it is even feasible)



Assessment & Placement Policy

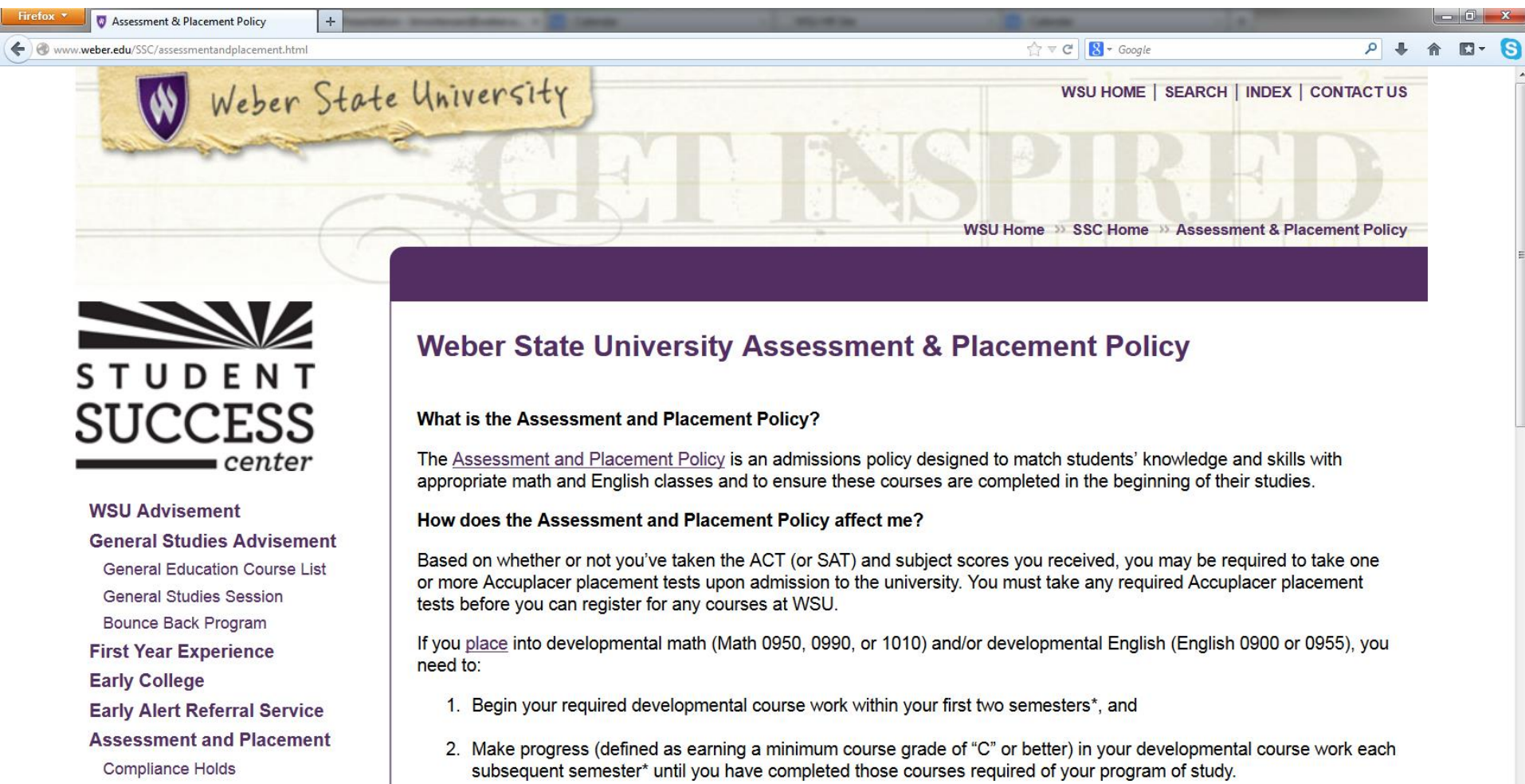

Firefox Assessment & Placement Policy +

www.weber.edu/SSC/assessmentandplacement.html

Google

WSU HOME | SEARCH | INDEX | CONTACT US

WSU Home » SSC Home » Assessment & Placement Policy

Weber State University Assessment & Placement Policy

What is the Assessment and Placement Policy?

The [Assessment and Placement Policy](#) is an admissions policy designed to match students' knowledge and skills with appropriate math and English classes and to ensure these courses are completed in the beginning of their studies.

How does the Assessment and Placement Policy affect me?

Based on whether or not you've taken the ACT (or SAT) and subject scores you received, you may be required to take one or more Accuplacer placement tests upon admission to the university. You must take any required Accuplacer placement tests before you can register for any courses at WSU.

If you [place](#) into developmental math (Math 0950, 0990, or 1010) and/or developmental English (English 0900 or 0955), you need to:

1. Begin your required developmental course work within your first two semesters*, and
2. Make progress (defined as earning a minimum course grade of "C" or better) in your developmental course work each subsequent semester* until you have completed those courses required of your program of study.

STUDENT SUCCESS center

WSU Advisement

General Studies Advisement

- General Education Course List
- General Studies Session
- Bounce Back Program

First Year Experience

Early College

Early Alert Referral Service

Assessment and Placement

- Compliance Holds

WEBER STATE UNIVERSITY

Assessment & Placement Policy

- An admissions policy that matches students' knowledge and skills with appropriate math/English classes.
- Also ensures these courses are completed in the beginning of their studies.
- Based on ACT/SAT subject scores, students may be required to take one or more Accuplacer tests before registering for any courses at WSU.



Student Retention

Institution	Admit Rate	1-year retention rate	change from previous year	Institution	Admit Rate	1-year retention rate	change from previous year
University of North Florida	64%	83%	same	Eastern Kentucky University	72%	69%	same
Weber State University	100%	73%	1%	Boise State University	87%	69%	same
Clarion Univ of Pennsylvania	68%	72%	same	Northern Kentucky University	69%	69%	2%
NW State University of Louisiana	81%	71%	2%	Youngstown State University	100%	68%	-2%
University of Alaska Anchorage	72%	71%	-2%	Utah Valley University	100%	65%	5%
Ferris State University	55%	70%	2%				



Facts & Figures

COMPLETION



WEBER STATE
UNIVERSITY

Type of Degrees Awarded

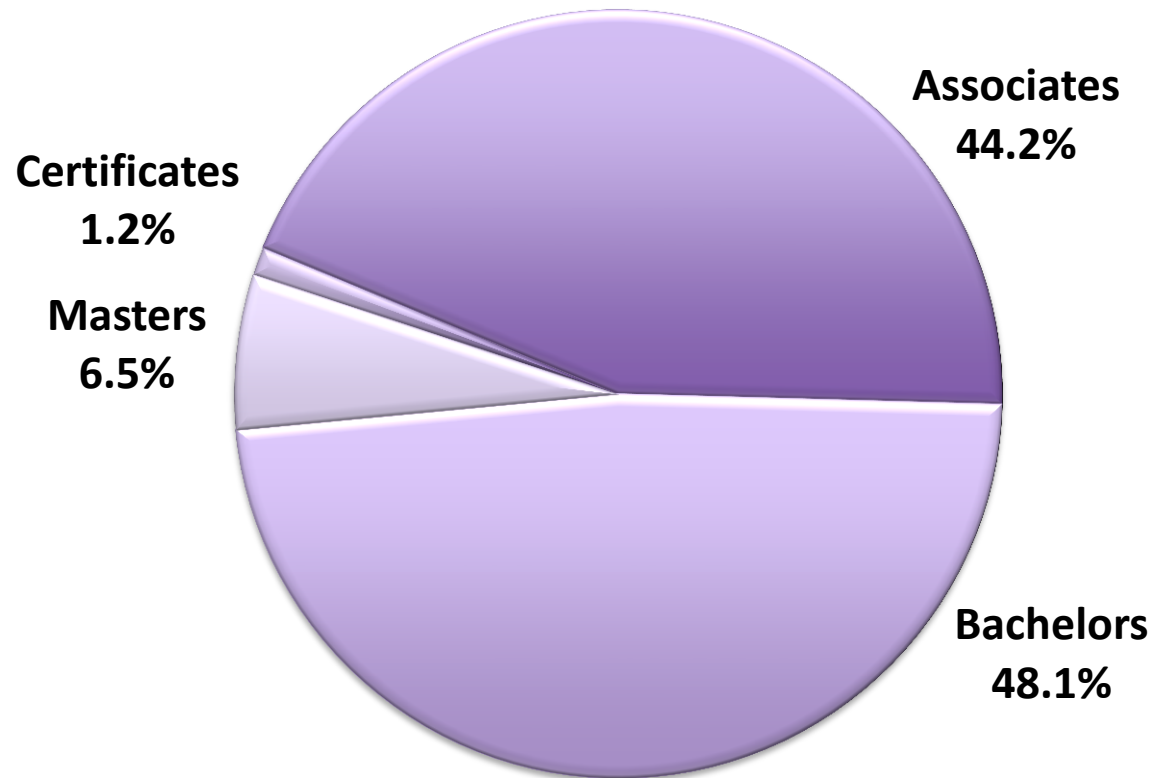

2011-12 Academic Year



WEBER STATE
UNIVERSITY

Top 10 Degree Programs

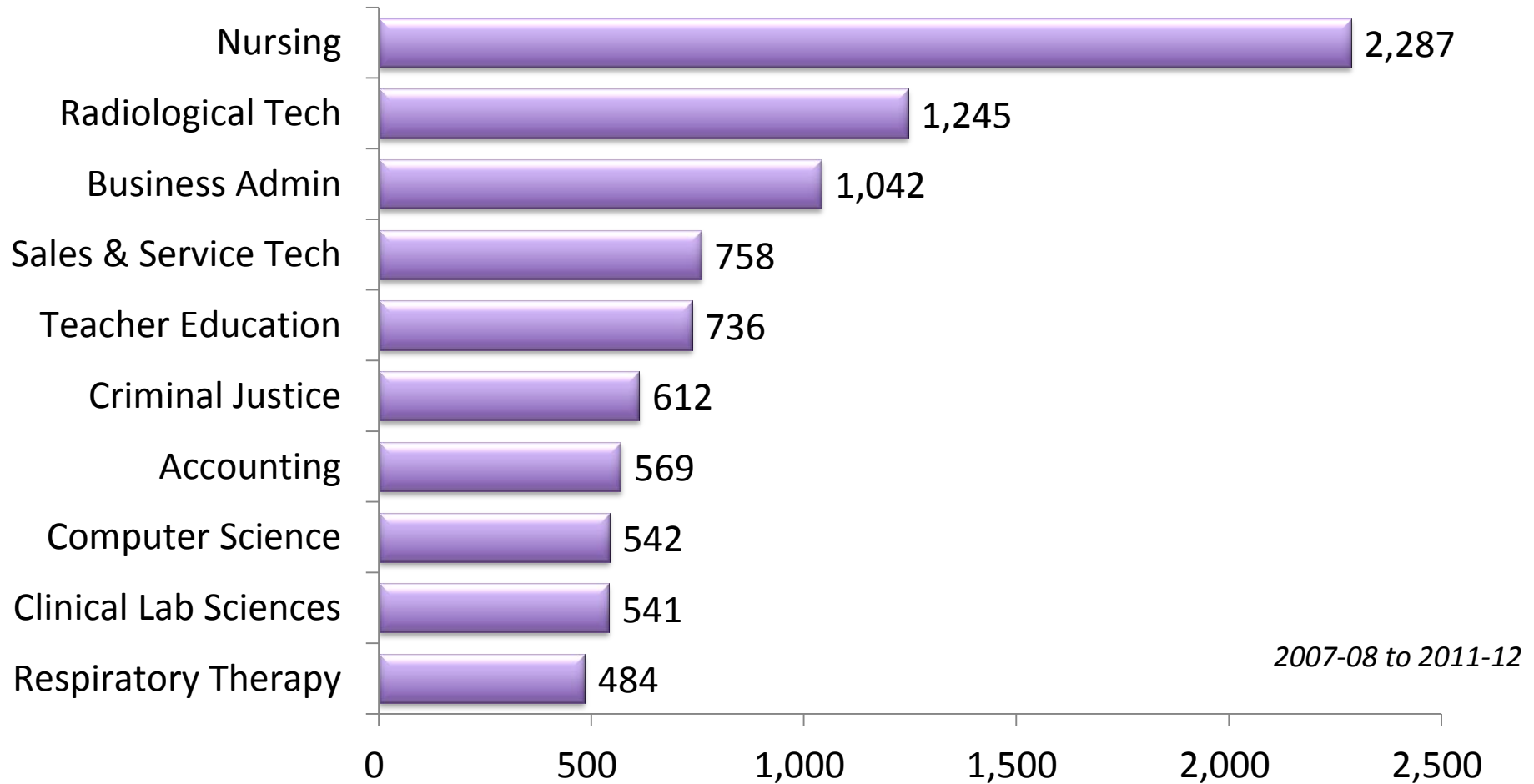

Completions per 100 FTE Students (2006-10 Average)

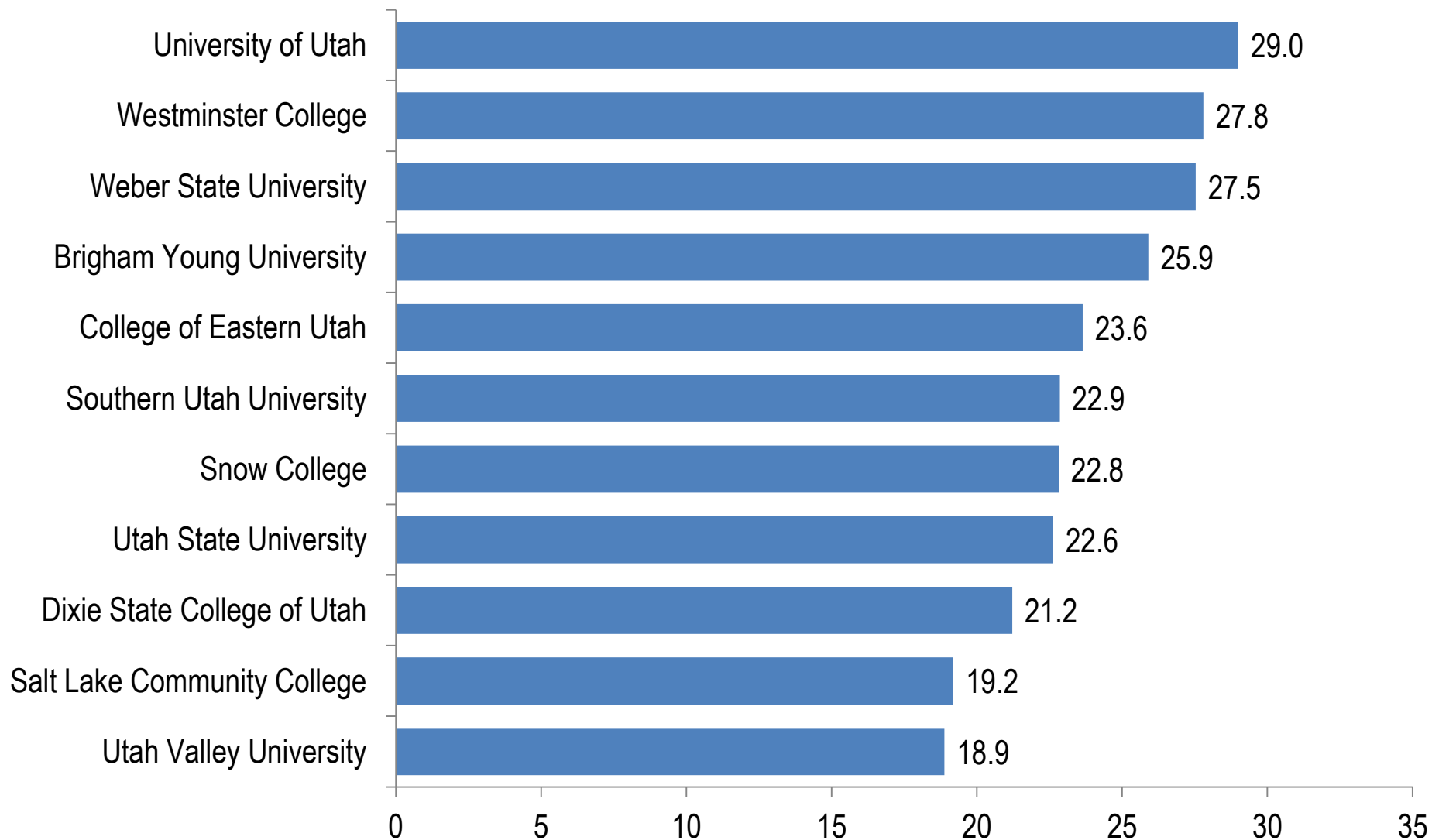

Education & Related Costs per Completion (2006-10 Average)

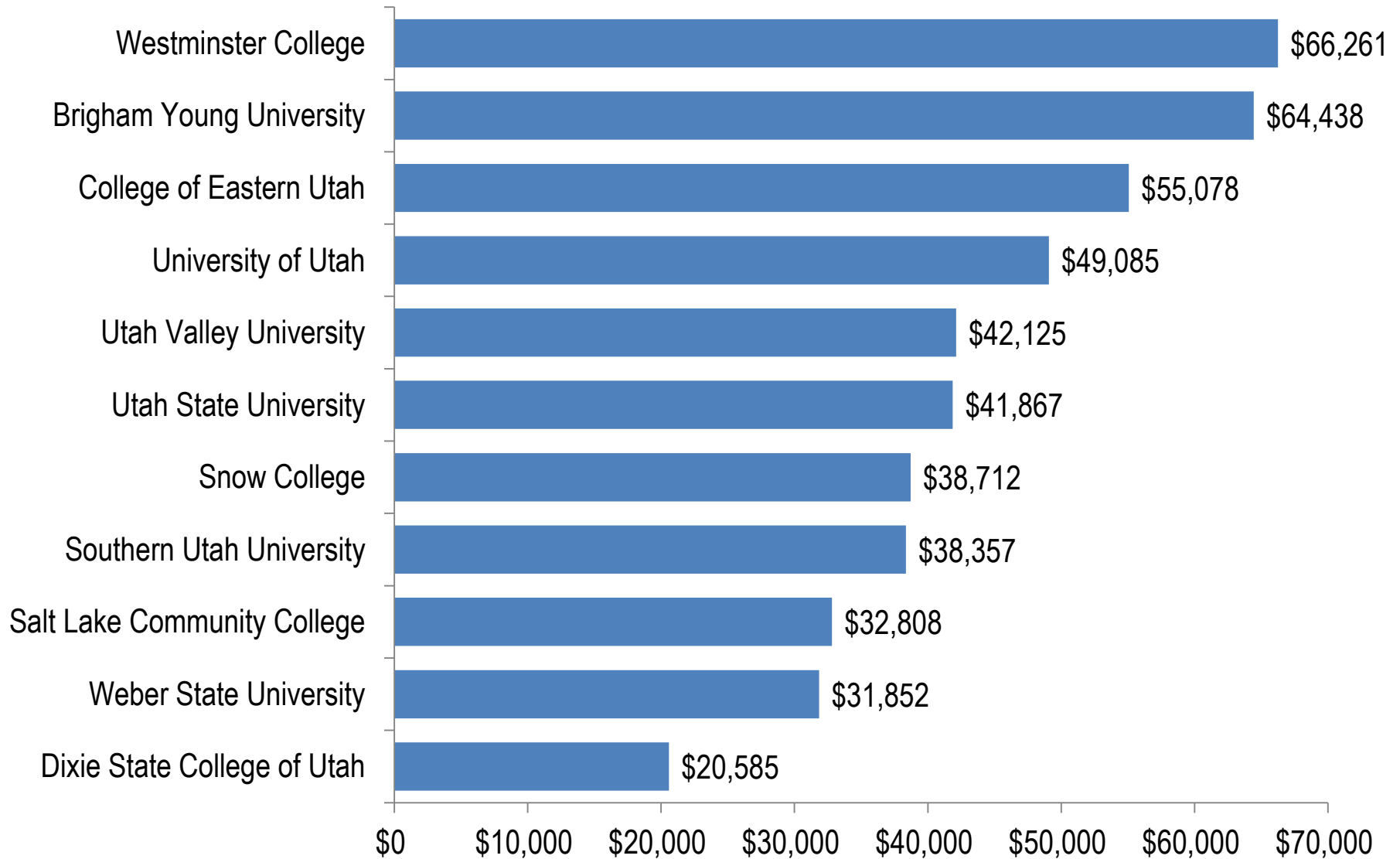

Facts & Figures

OUTCOMES



WEBER STATE
UNIVERSITY

2011-12 Bachelor's Degree Employment Information

College	Employed Full Time	Average Annual Salary
Arts, Humanities, and Social Sciences	84%	\$32,665
Business and Economics	84%	\$39,313
Education	64%	\$29,506
STEM (COAST, Science, Health Professions)	90%	\$45,834
Overall	82%	\$40,214



DIRECTIONS



WEBER STATE
UNIVERSITY

Update to University Signature

Current Signature



Updated Signature



WEBER STATE
UNIVERSITY

An updated agenda



- Organized around the current and continuing three core themes of WSU.
- Overarching design to create a 100% commitment to the WSU student experience.



Community



- College Town partnership
 - Service Learning classes
 - Downtown building
- Expansion of internships
 - Business
 - Science
 - Politics



Learning



- More effective use of technology in teaching
 - Online education
 - Hybrid classes
 - Peer instruction
- World-class classrooms, laboratories and facilities
 - Science Lab Building



Capital Facilities

WSU Science Lab Replacement
\$3,500,000 for design funding

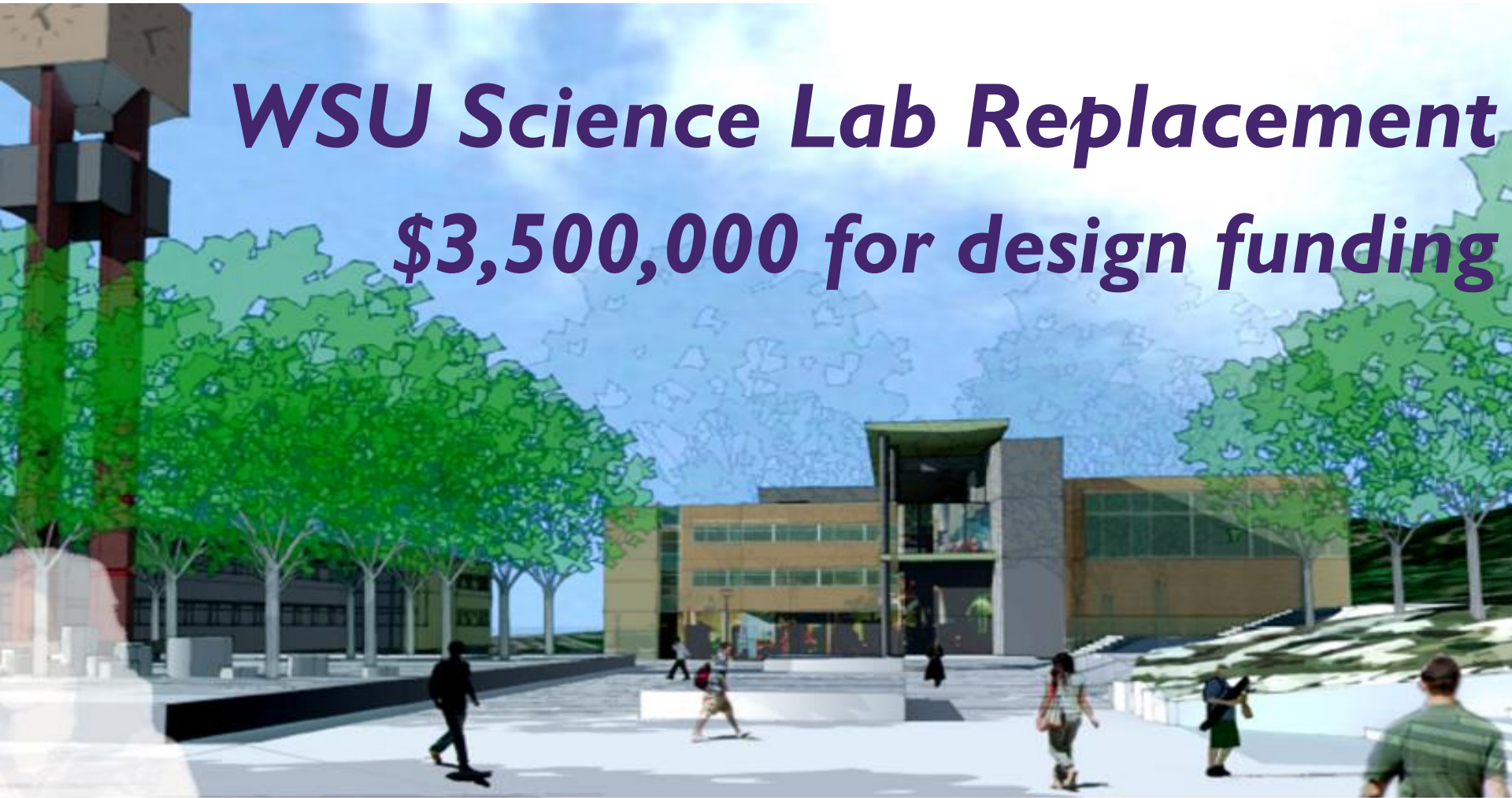

WEBER STATE
UNIVERSITY

Access



- Alignment with public ed
 - Setting high expectations
 - Student-centered preparation
 - Recruitment and retention of underrepresented students
- Dream Weber
 - Expanded eligibility to \$30,000 household income



WEBER STATE
UNIVERSITY



WEBER STATE
UNIVERSITY

Questions?

cwright@weber.edu



WEBER STATE
UNIVERSITY